



WALRUS
PUMP

TPHK(S)E Series

Immersible Pump

IE3 
Motor



**Better Life
Through Innovation**

TPHK Series Immersible Pump

50 Hz

Power: 1.1 - 3.4 kW
 Head: Up to 60 M
 Flow: Up to 200 L/min
 Outlet: 1"

60 Hz

Power: 1.1 - 3.7 kW
 Head: Up to 86 M
 Flow: Up to 230 L/min
 Outlet: 1"



Product Features

- Immersible vertical multistage centrifugal pump, self-priming, co-axial pump/motor design, impellers mounted on extended motor shaft. Main working parts made by stainless steel.

Applications

The TPHK Series is vertical multistage centrifugal pump, designed for industrial use, specially for machine tools. It is suitable to carry fluids such as water, coolant, light oil and other clean, non aggressive matters:

- Industrial circulation system
- Washing/cleaning system
- Filtration system

Model Code

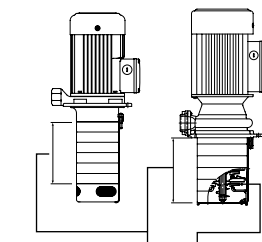

Model type	TPHK 8T	4	-	4	S	E
Standard capacity m ³ /h						
Number of Stages (n-1)						
Number of Impellers						
Stainless steel series						
Drain back tank structure						

Operating Conditions

- Ambient temperature: Max. +40°C
- Liquid temperature range: +0°C ~ +90°C
- Operating pressure: Max. 10 kg/cm²
- Submerged depth: Min. 40 mm

Motor

- Enclosure protection class: IP54
- Insulation class: F.
- Frequency range: 50/60 Hz
- Nominal speed: 2900/3500 rpm
- Voltages code:

Code	PH	50Hz	60Hz
A6V*	3	200-230/342-415V	220-240/380-480V
A9V*	3	200-230/342-380V	220-240/380-440V

* The motor can be used in both 50/60Hz.

Sectional Drawing

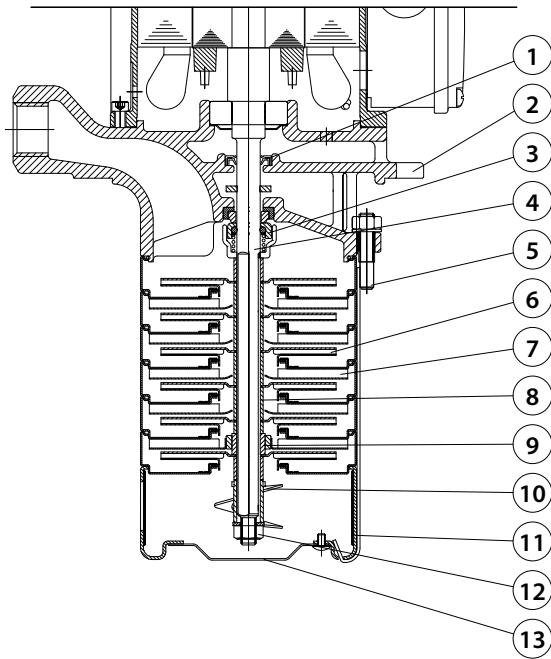

Materials

NO.	Part Name	Material	
		Standard	S series
1	Oil Seal		NBR
2	Pump Casing	FC 25	SUS 304
3	Mechanical Seal		MSSH
4	Shaft		SUS 304
5	Strap		SUS 304
6	Impeller		SUS 304
7	Intermediate chamber		SUS 304
8	Sleeve		SUS 304
9	Bearing		SiC
10	Priming screw		SUS 304
11	Suction intercon-necter		SUS 304
12	Lock Nut		SUS 316
13	Filter		SUS 304
14	Flange		SUS 304

SUS 304 may be replaced by SUS 316, depending on stock availability.

Options on Request

■ Special mechanical seal

Mechanical seal type	Material	
	Stationary Face/ Rotary Face	Cup Gasket & O Ring
MGSH MGSV MGSE	(G)Carbon/ (S)Silicon carbide	(H) HNBR (V) Viton (E) EPDM
MSSH MSSV MSSE	(S)Silicon carbide/ (S)Silicon carbide	

Electrical Data, 50/60Hz

Model	PH Ø	Voltage code	Cycle Hz	Volts V	Output kW	Ampere I _{1/1} (A)	Service Factor	Ampere I _{max} (A)
TPHK 8T2-2(S)E	3	A6V	50	200-230/342-415	1.1	5.2-5.4/3.1-3.4	1.1	5.5-5.7/3.3-3.5
			60	220-240/380-480	1.1	4.6-4.6/2.8-3.1	1.4	6.2-5.7/3.6-3.5
TPHK 8T3-3(S)E	3	A9V	50	200-230/342-380	2.2	9.5-10.5/5.5-5.6	1.1	10.2-10.9/5.9-5.9
			60	220-240/380-440	2.2	8.6-8.4/4.9-5.0	1.5	12.1-11.2/6.9-6.4
TPHK 8T4-4(S)E	3	A9V	50	200-230/342-380	2.2	9.5-10.5/5.5-5.6	1.1	10.2-10.9/5.9-5.9
			60	220-240/380-440	2.2	8.6-8.4/4.9-5.0	1.5	12.1-11.2/6.9-6.4
TPHK 8T5-5(S)E	3	A9V	50	200-230/342-380	3.0	12.2-13.1/7.1-7.1	1.1	13.4-14.0/7.9-7.8
			60	220-240/380-440	3.0	11.2-10.7/6.4-6.3	1.3	14.5-13.3/8.3-7.6
TPHK 8T6-6(S)E	3	A9V	50	200-230/342-380	3.4	13.4-13.0/7.8-7.4	1.1	14.6-13.9/8.5-8.0
			60	220-240/380-440	3.7	13.4-12.6/7.7-7.0	1.3	16.4-15.1/9.4-8.4

Dimensions

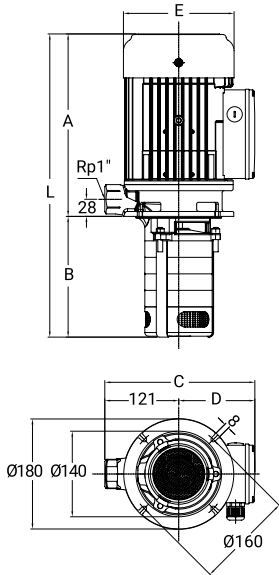

Model	Cycle Hz	L mm	A mm	B mm	C mm	D mm	E mm	N.W. kg	
TPHK 8T2-2(S)E	50/60	455	284	171	232	111	145	17	24
TPHK 8T3-3(S)E	50/60	519	321	198	244	124	181	24	24
TPHK 8T4-4(S)E	50/60	546	321	225	244	124	181	25	24
TPHK 8T5-5(S)E	50/60	598	346	252	244	124	181	28	15
TPHK 8T6-6(S)E	50/60	645	366	279	244	124	181	31	15

Performance Curve, 50Hz

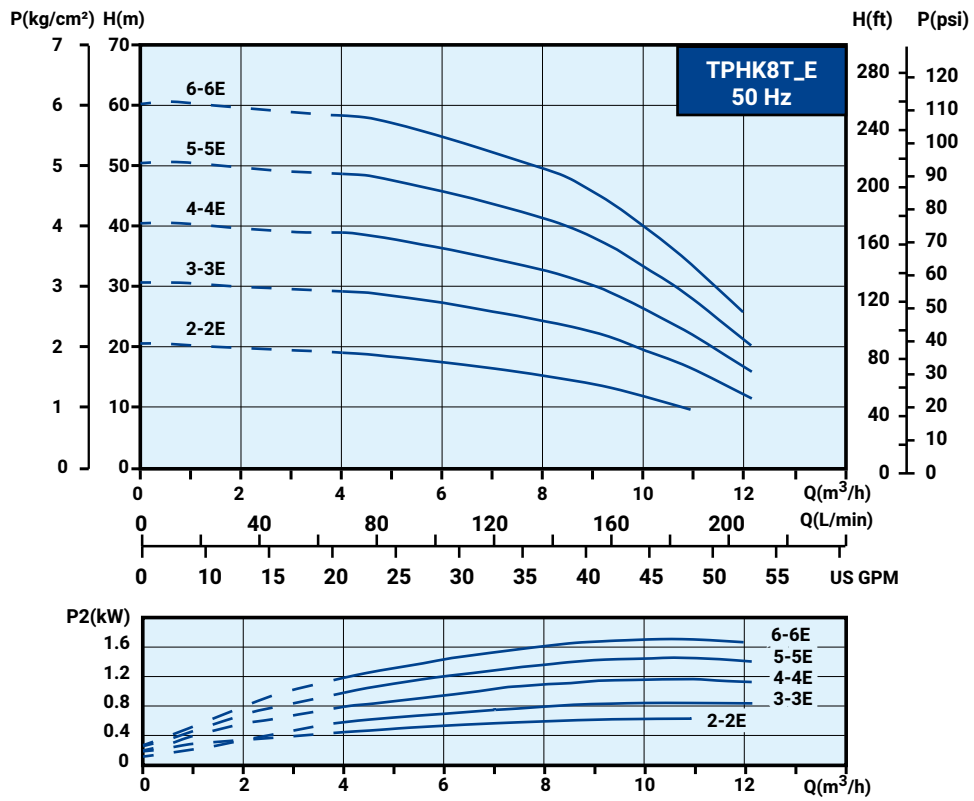

Performance Curve, 60Hz

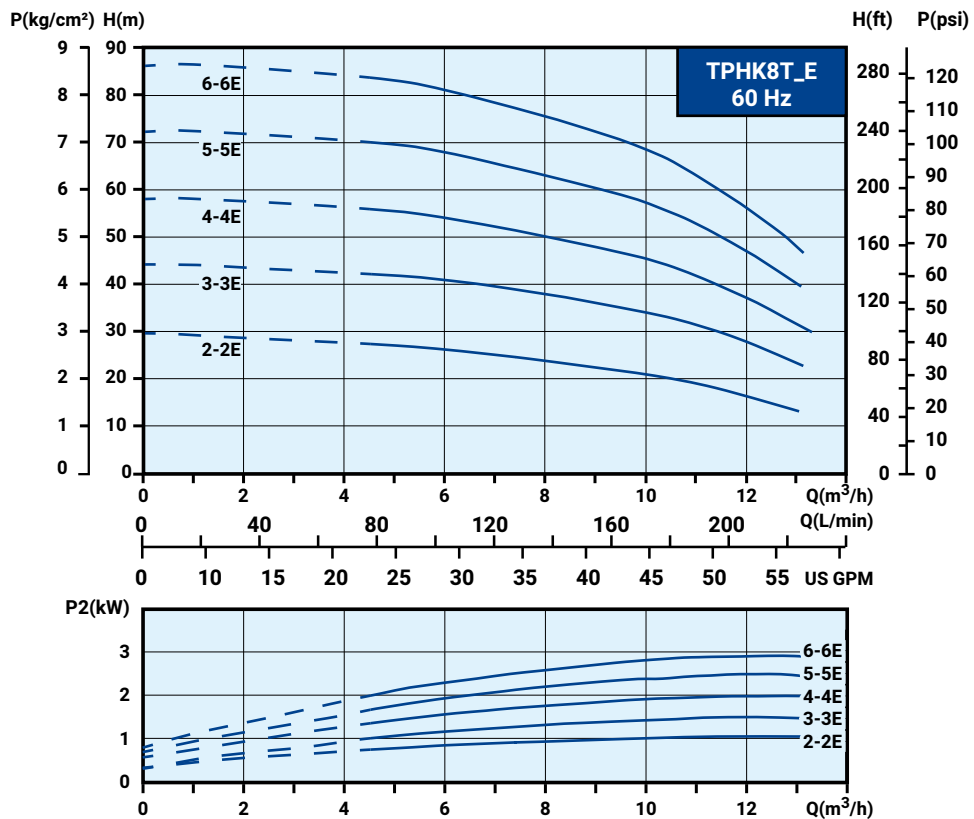

Memo



Memo





WALRUS
PUMP

WALRUS PUMP CO., LTD.

Head office: No.83-14, Dapiantou, Sanzhi Dist.,

New Taipei City 252, Taiwan

Tel: (+886) 2 2636-1123~7

Fax: (+886) 2 8635-2660

Email : walrus.sales@walrus.com.tw



All specifications are subject to change without notice. TPK(S)E-EN003-202412

